

ZONING MAP

TOWN OF GILCREST

WELD COUNTY, COLORADO

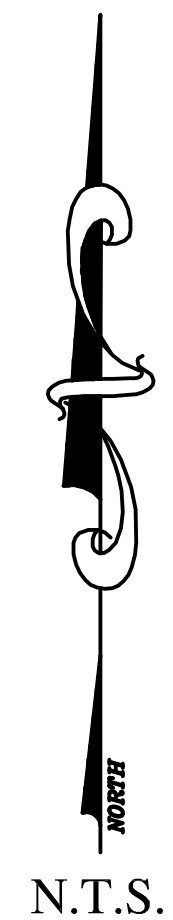
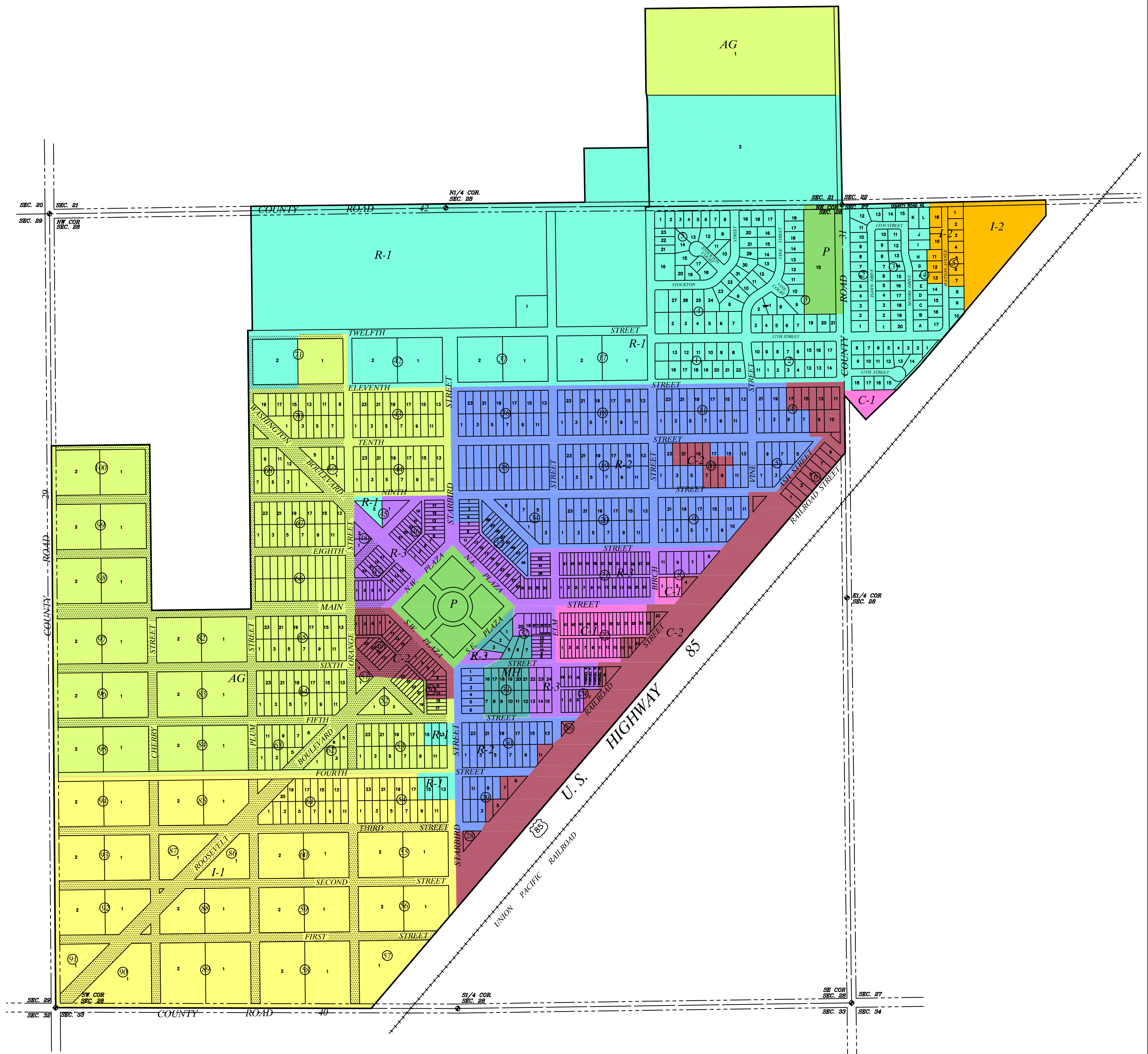

OFFICIAL ZONING MAP OF THE TOWN OF GILCREST
 AS AMENDED:
 ZONING ORDINANCES 1998-4, 2003-02, 2004-04
 ADOPTED APRIL 20, 1998 APRIL 21, 2003 JULY 19, 2004

DATE: OCTOBER 2004

- CORPORATE LIMITS
- SECTION LINE
- RIGHT-OF-WAY LINE
- RAILROAD TRACKS
- ▨ VACATED STREETS; LAND REVERTED BACK TO ADJOINING LOTS

ZONING LEGEND

- AG** AGRICULTURAL
- R-1** LOW DENSITY RESIDENTIAL
- R-2** MEDIUM DENSITY RESIDENTIAL
- R-3** HIGH DENSITY RESIDENTIAL
- MH** MOBILE HOME
- C-1** LIGHT COMMERCIAL
- C-2** HEAVY COMMERCIAL
- I-1** LIGHT INDUSTRY
- I-2** HEAVY INDUSTRY
- P** PARKS & OPEN SPACE